



CRAFTING IDEA

GB

Put your gnome under a dome.  
Charming Christmas deco-  
ration.

[WWW.RAYHER.COM](http://WWW.RAYHER.COM)



## Used items:

<b>46 672 505</b>	Wood insert-in piece Gnome, FSC Mix Credit, natural	1 piece
<b>46 122 000</b>	Plastic dome with base, 8 cm ø	1 piece
<b>38 000 100</b>	All-purpose paint, snow-white	1/40 bottle
<b>38 000 286</b>	All-purpose paint, cherry red	1/100 bottle
<b>38 000 509</b>	All-purpose paint, taupe	1/80 bottle
<b>38 000 446</b>	All-purpose paint, black forest	1/80 bottle
<b>38 000 374</b>	All-purpose paint, azure blue	1/100 bottle
<b>38 075 000</b>	Snow pen	1/50 bottle
<b>35 014 616</b>	Extreme Sheen, gold	1/40 bottle
<b>33 487 000</b>	Glue Fix pen	1/100 bottle

## Additionally you need:

<b>37 311 00</b>	Synthetic paintbrush set
------------------	--------------------------

## Instruction:

**1** Paint the 2 gnome-shaped wooden insert-in pieces with the white, taupe and cherry red all-purpose paints and with the gold Extreme Sheen paint.

**2** To paint the fir tree, mix a little bit of the azure blue all-purpose paint with the black forest all-purpose paint and dilute the resulting mixture with water to achieve a glazed effect. For optimal 3D snow effect, apply the Snow pen on the branches of the tree.

**3** Use the Glue Fix pen to glue the painted and dry wooden insert-in pieces into the cutouts provided for this purpose within the baseplate. Now you can decorate the base with the Snow pen and scatter the stars onto the wet snow. Allow to dry well out.

**4** Finally, as a last step, glue the baseplate in the middle of the plastic dome holder and cover it all with the plastic dome.

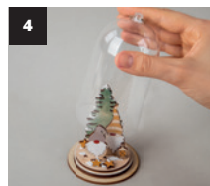
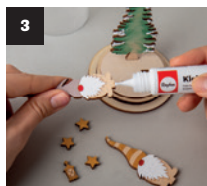
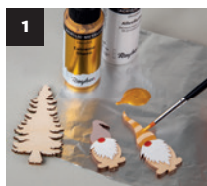

*Rayher.*

[WWW.RAYHER.COM](http://WWW.RAYHER.COM)

More craft ideas and additional material information can be found on our website.

