



CRAFTING IDEA

GB

Round and plain.
Natural wall hanging decor.

WWW.RAYHER.COM



Used items:

65 397 505	Viennese wickerwork, natural	20 × 9 cm
62 400 000	Wooden chip box, round	bottom part
35 047 102	Chalky, white	some
55 832 576	Sisal rope in ball, ø 1 mm, black	5.2 m
65 029 00	Rattan strip, 4 mm	1.13 m

Additionally you need:

Flat paintbrush, pencil, scissors, hot-melt glue



Instructions:

- 1** Paint the inside of the wooden chip box with Chalky white paint. Let it dry.
- 2** Place half of the open side of the wooden chip box on the rear side of the Viennese wicker to trace the outline of this half, which should be about 9 cm high. Use the pencil to trace the outline of half the wooden chip box, then cut it out. Then glue this same Viennese wicker half to the front edge of the wooden chip box using hot-melt glue.
- 3** Wrap the top outer edge (1.5 cm wide) of the wooden chip box with sisal cord and secure it with the hot-melt glue.
- 4** Then glue a rattan strip to the inside edge of the open surface of the wooden chip box. Glue also a rattan strip with the hot-melt glue to the edge of the Viennese wicker and below the black sisal cord. This will make a lovely decorative border.

Decorate with a real or artificial plant.

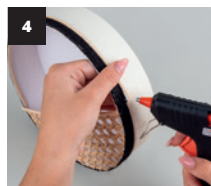
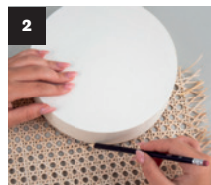



Used items:

65 398 505	Rattan wickerwork, natural	19.5 cm circle
62 400 000	Wooden chip box, round	lid
35 047 102	Chalky, white	some
55 832 576	Sisal rope in ball, ø 1 mm, black	5.2 m
65 029 00	Rattan strip, 4 mm	0.62 m
85 493 000	Eucalyptus bunch with paper sleeve	1 twig

Additionally you need:

33 487 000 Glue Fix pen
Scissors, flat paintbrush, hot-melt glue, pencil



Instructions:

- 1 Paint the inside of the wooden chip box lid with Chalky white paint. Let it dry.
- 2 Trace the outline of a circle with a diameter of 19.5 cm on the rattan wicker and cut it out with scissors.
- 3 Apply glue to the rear side of the rattan wicker with the Glue Fix pen, then glue the rattan wicker circle to the inner side of the lid. Press down and hold until the glue has set and the circle has completely adhered to the surface.
- 4 Completely cover the outer edge of the lid with the black sisal rope and secure it in place with the hot-melt glue. Glue the corresponding length of rattan strip to the top inside edge of the lid and secure it in place with the hot-melt glue.
- 5 Glue decoratively the eucalyptus twig in the middle of the lid.



Rayher.

WWW.RAYHER.COM

More craft ideas and additional material information can be found on our website.

