



CRAFTING IDEA

GB

Nicely illuminated.
Star wreath with a lot of
character.

WWW.RAYHER.COM



Used items:

25 055 00	Metal ring, coated, white, 35 cm ø	1 piece
62 833 000	Wooden holder with 3 slots, 18 × 5 cm	1 piece
46 322 000	Wooden motifs Tree & Deer, 3-10,8 × 3-18,5 cm	1 piece
38 000 100	All purpose paint, snow-white, 59 ml	1/5 bottle
34 003 00	Snow spray, suitable for styrofoam, 150 ml	1/20 can
67 252 102	Mini paper bag XXS, white, 50 pieces	4/5 bag
69 169 159	Mini LED chain of lights with wire/timer, light-yellow, 220 cm	1 piece
66 063 000	Deco-Snowy fir tree	1 set
66 075 444	Decorative fir trees, snow-covered, pine green	1 set
30 069 000	Special double-sided adhesive tape, 20 m (for the star)	1.2 m
30 202 000	Double-sided adhesive tape, extra strong, 10 m (to affix the stars onto the ring)	0.5 m

Additionally you need:

37 053 000	Set of brushes Hobby Kreativ	
89 379 00	Pointed paper scissors	
	AA batteries	3 pieces



Instruction:

Paint the holder with grooves and the wooden motifs by means of the paintbrush and the All-purpose paint. Depending on the degree of opacity you wish to achieve in the white colour, you could paint the motifs one more time after they have dried out. Then insert the painted fir trees into the back groove of the holder and spray the trees and the holder from above with a little Snow spray.

Now wind twice the LED chain of lights around the metal ring.

TIP: It looks particularly nice when the chain of lights is wound widespread and the LED lights are equally spaced apart. Thus, the lights are placed later in the middle of each star.

1 Cut to size the paper mini bag XXS 40 times with the paper scissors using the cutting template (see next page).

2 For one star, make two half-stars out of 4 bags each. Stick precisely those 4 bags together by means of the 3 mm special double-sided adhesive tape.

3-4 Now affix the star halves to the ring at both the bottom and the top using the special double-sided adhesive tape (With LED light in the middle of each star).

Now you can insert the ring with the stars and the deer into the groove of the wood holder and, if necessary, affix them with the double-sided adhesive tape (extra strong).

At long last, place the star wreath at the desired spot and adorn it with the decorative fir trees and snowflakes.

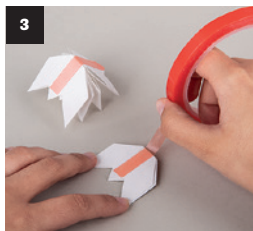

Rayher.

WWW.RAYHER.COM

More craft ideas and additional material information can be found on our website.



Cutting template:

