

The Rayher logo is a white circle containing the brand name 'Rayher.' in a black, cursive-style font.

JUST CREATE



CRAFTING IDEA

GB

Christmas is going to be colourful. Baubles made from pine cones.

WWW.RAYHER.COM



Used items:

76 016 999	Pompoms, ø 1-3 cm, colourful	1/10 pack
89 209 00	Wiggle eyes, assorted	6 pieces
52 138 000	Chenille wire mix	3 pieces
51 300 31	Deco cord of cotton, ø 1 mm, natural	approx. 150 cm

Additionally you need:

33 487 000 Glue Fix pen
Pine cones gathered in the wild, scissors

Instructions:



FOR 3 PINE CONES

1 Start by putting a drop of glue on the lowest scale of the pine cone in the sequence that you wish. Take your pick among the differently coloured pompoms and stick them on spots covered with glue. Do the same on the other pine cone scales until they are entirely decorated. Let the pompoms dry well out.

2 Cut the cords to a length of between 20 and 30 cm for each pine cone. Tie the ends together. Affix the cord as a suspension hook to the pine cone axis by means of the Glue Fix pen.

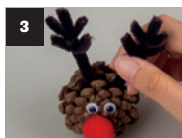
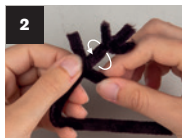

FOR 3 REINDEERS

1 First of all, create your reindeer face on the pine cone axis using wiggle eyes and a pom-pom as a nose. You can add a mouth if desired with about 2 cm long piece of decorative cord.

2 Now you need a piece of chenille wire about 16 cm long, which you shape into a "V" letter (serving as antlers). Cut off 4 more pieces of the same colour measuring about 4-5 cm. Wind two short pieces of the same colour around each main beam of the antlers, at a distance of about 1 cm. Shape them into a small "V" letter and cut them evenly.

3 Affix the finished antlers to the first pine cone scale with a drop of glue.

4 Cut the cords to a length of between 20 and 30 cm for each reindeer. Tie the ends together. Affix the cord directly behind the antlers by means of the Glue Fix pen.

Finally, hang all the pine cones you've designed on a fir branch or twig.

Rayher.

WWW.RAYHER.COM

More craft ideas and additional material information can be found on our website.

