



HANDICRAFT TIP

GB

Monsters coming up.
Matchboxes as a children's
room decoration.



Used items:

67 381 521	Matchbox XL, FSC Mix Credit, kraft	4 pieces
45 108 000	Stencil "Little monster"	1 piece
38 046 213	Acrylic craft paint, capri-orange	1/10 bottle
38 046 576	Acrylic craft paint, black	1/10 bottle
89 209 00	Wiggle eyes, assorted	5 pieces
69 263 000	Wiggle eyes Glow in the dark, assorted	2 pieces
55 517 576	Yarn, 1 mm ø, black	approx. 1 m
55 517 210	Yarn, 1 mm ø, orange	approx. 1.5 m
33 487 000	Glue Fix pen	approx. 5 g
34 014 00	Glue spray, non-permanent	1 piece

Additionally you need:

37 060 000	Paintbrush set Stencilling, FSC 100%	1 piece
89 378 00	Craft scissors	1 piece

Tinfoil, paper towel



Instruction:

1 Spray the spray glue on the rear side of the "Little monster" stencil and let it air-dry briefly. Lay the stencil on the three matchboxes as shown in picture and stencil them with the paintbrush from the stencilling paintbrush set and with the acrylic craft paints of capri-orange and black colours. Then remove and clean the stencil right away. Let the paint dry well out.

2 As for the fourth matchbox, paint its inner side and its rim with the acrylic craft paint of capri-orange colour. Let it dry out.

3 Cut the side with the monster from one of the stencilled matchboxes and glue the cutout inside the painted box using the Glue Fix pen.

4 Outline the monster's mouth by means of the orange-coloured yarn and affix it with the Glue Fix pen.

5 After all that, place the wiggle eyes, stick them down with the Glue Fix pen and decorate the cheerful monster boxes with orange and black yarns and the remaining wiggle eyes.

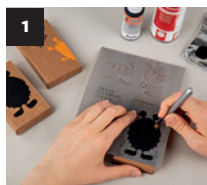

Rayher.

WWW.RAYHER.COM

More craft ideas and additional material information can be found on our website.

