



CRAFTING IDEA

GB

# Macrame lamp



## Used items:

<b>23 028 02</b>	Lampshade, round, white	1 piece
<b>23 089 000</b>	Ceramic lampstand „Stockholm“, VDE	1 piece
<b>44 001 01</b>	Yarn, 2 mm ø, black	50,7 m
<b>89 378 00</b>	Craft scissors	
<b>33 376 00</b>	Mini hot glue gun, low temp.	

## Instructions:

- 1 Cut a string (yarn) to size of  $1 \times 1,70$  m and  $35 \times 1,40$  m. In order to prevent the cords from unravelling, knot each end individually. Lay the 1.70 m long cord folded in half and attach it to the lampshade according to its diameter with an overhand knot.
- 2 Hang up the remaining cords consecutively.
- 3 Affix the already prepared ring to the lampshade by means of the hot glue.
- 4 Tie a weaver knot with 4 cords. Repeat this step continuously.
- 5 For the 2nd - 4th row, tie a half of each two knots with a weaver knot. Since the lampshade is conical, increase slightly and respectively the spacing between rows.
- 6 Tie two knots next to each other for the tapered tips.
- 7 Make another knot under the two knots. Replace the threads and set the last knot of the tip.
- 8 Finally, put the lamp at the edge of the table so that the cords can be shortened evenly.

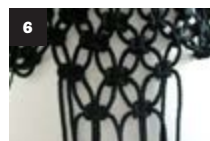
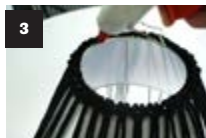

# Rayher.

[WWW.RAYHER.COM](http://WWW.RAYHER.COM)

© 2019, Rayher Hobby GmbH

You will find material specifications and instructions on our homepage.