



CRAFTING IDEA

GB

Like cut-out biscuits. Designing magnets and pendants.



Used items for 8 cut-out shapes: (4 magnets, 4 pendants)

34 502 00	Air-drying modelling clay, white	300 g
34 502 72	Air-drying modelling clay, terracotta	300 g
89 211 00	Magnet, 13 mm, 5 mm thick	4 pieces
14 874 999	Diamond Glass mosaic stones, round, colourful	1/5 pack
33 487 000	Glue Fix pen	2/30 bottle (2 g)

Additionally you need:

Cookie cutter shapes Christmas tree and star, rolling pin, cling foil, knife, wooden skewer

Instructions:

1 Cut off a piece of the modelling clay with a knife and roll it out to around 5 mm thick.

TIPP: Roll the modelling clay out on a cling foil placed on a solid surface so that you can easily remove it afterwards.

2 Just as baking biscuits, cut out stars and Christmas trees using the cookie cutters.

3 When it comes to pendants, you can use a wooden skewer to make a hole at the desired spot in the modelling clay. Set the finished cut-out clay pieces aside to dry. It takes about 2 days for the modelling clay to dry completely.

TIPP: At a low drying temperature and with extra ballast to weigh down slightly the cookie cutters, e.g. an empty cardboard box, you will get nice and flat shapes.

4 Once the stars and trees are dry, you can glue on the Diamond Glass mosaic stones with different patterns. With the Glue Fix pen, it's a cinch! To make the fridge magnets, affix one magnet to the rear side of each cut-out item using the Glue Fix pen.

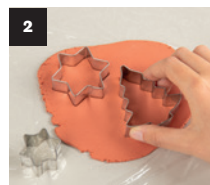

Rayher.

WWW.RAYHER.COM

More craft ideas and additional material information can be found on our website.

