



CRAFTING IDEA

GB

Colourfully patterned.
Tray with triangular mosaic tiles.

WWW.RAYHER.COM



Used items:

64 673 000	Wooden tray, ø 20 cm, natural	1 piece
14 879 999	Triangle Glas mosaic mix, colourful	2/3 pack
14 601 00	Joint sealant, white, first quality	1/2 jar
35 077 100	Allround Paint, acrylic, snow-white	1/10 bottle

Additionally you need:

30 240 000	Mosaic glue, water-based
38 032 00	Metallic spatula with flexible blade tip
38 241 00	Painting sponge
Mixing vessel for joint sealant, cotton cloth, paintbrush	



Instructions:

- 1 Paint the inner rim of the tray with the white acrylic paint. Begin with the row of mosaic tiles along the round rim of the tray, place the triangular mosaic tiles so that the base and vertex of the triangles alternate between facing inwards and outwards. Glue down each tile firmly. Cover the rest of the tray surface in the same way, while gluing the mosaic tiles firmly in place.
- 2 Spread the joint sealant evenly over the mosaic tiles using a spatula.
- 3 Remove excess joint sealant and polish the tiles with a sponge or wet cotton cloth.

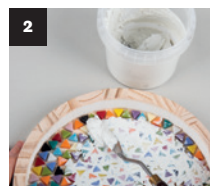

Rayher.

WWW.RAYHER.COM

More craft ideas and additional material information can be found on our website.

