



CRAFTING IDEA

GB

Picture-in-picture.
Botanical art inside a tray.

WWW.RAYHER.COM



Used items:

64 653 505	Wood deco tray set, natural	1 piece
38 239 000	Structural paste, coarse	¼ jar
38 759 000	Putty paste	¼ jar
85 032 11	Icelandic moss, light green	1/3 bag
85 032 31	Icelandic moss, natural	1/3 bag
85 491 104	Dried flower bouquet, ivory	1 bag
81 283 06	Mirror foil, gold	1/2 sheet

Additionally you need:

33 384 00	Glue for foil
33 407 00	Craft glue
38 032 00	Metallic spatula with flexible blade tip
30 071 00	Double-sided adhesive tape extra strong 2 m

Natural twigs, hot-melt glue, paintbrush, cling foil



Instructions:

- 1 Spread the putty paste over the square-shaped tray using a metallic spatula. Press the cling foil onto the still wet putty and remove it instantly. This is how a raised surface is achieved.
- 2 Spread now the structural paste onto rectangular tray using again the metallic spatula. Using the tip of the paintbrush handle, for example, make several grooves on one side, from top to bottom, in the still wet paste. Allow to dry thoroughly.
- 3 To make the outer edge of the large tray gold, carefully stick the double-sided adhesive tape onto the edge, remove the protective sheet and stick the mirror foil onto it.
- 4 Glue the Icelandic moss onto two square-shaped trays using the hot-melt glue.
- 5 Apply glue for foil in dots onto trays covered in structural paste and putty paste using the paintbrush. Let the glue dry, then put the mirror foil on.
- 6 Decorate the trays with natural raw materials to your liking. Use the hot-melt glue to bond them.

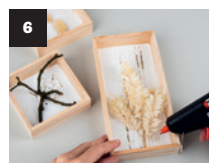

* Without drying time

Rayher.

WWW.RAYHER.COM

More craft ideas and additional material information can be found on our website.

