



CRAFTING IDEA

GB

Houses for the home. DIY glass lanterns.

WWW.RAYHER.COM



Used items:

46 759 000	Glass vase, 8 cm ø	2 pieces
46 754 505	Plywood mini houses, natural	½ bag
46 752 505	Plywood Light up houses, natural	½ bag
31 042 02	Wax pellets, white	600 g
31 653 000	Wooden wick with metal wick holder	2 pieces
42 000 504	Jute cord on wooden card, 1.5 mm ø, sand	1.2 m
61 102 00	Raw-wood beads, 4 mm ø	approx. 90 pieces

Additionally you need:

31 070 00	Adhesive wax squares
30 070 000	Double-sided adhesive tape extra strong

Wax melting accessories, scissors



Instructions:

Casting wax in glass

1 Insert the wooden wick into the metal holder and fix it in the middle of the glass by means of the adhesive wax square.

2 Carefully pour the melted wax pellets (see Wax Pellets instructions) between the wick and the wall of the glass. Allow to dry well out and shorten the wick.

Decorating

3 Glue the plywood houses onto the glass in the form of a border using the double-sided adhesive tape.

4 Cut the jute cord so that there is enough to thread the wooden beads onto it and wind it around the glass three times.
For the second glass candle jar with the large light houses, glue each plywood house separately and decorate them with natural cord and wooden beads.

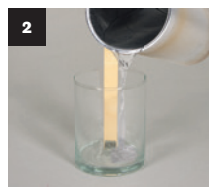

* without drying time

Rayher.

WWW.RAYHER.COM

More craft ideas and additional material information can be found on our website.

