



CRAFTING TIP

GB

Royal charm.
Turn any gift into an eye-catcher.



Used items:

36 073 000	Casting mould: circle, rectangle, oval	1 piece
34 406 102	Casting powder Raysin 100 white	approx. 30 g
35 016 304	Colour pigment, berry	1 knife tip
34 340 000	Label Star, 45mm ø	1 piece
68 053 606	String, 2 mm ø silver	50 cm
61 216 31	Craft wooden sticks	
62 039 00	Wooden skewers	
33 398 00	Special double-sided adhesive tape	
89 379 00	Pointed paper scissors	

Additionally you need:

Plastic cup
Sellotape



Instructions:

- 1 Place the label in the casting mould with a motif facing up. Affix it by means of the double-sided adhesive tape.
- 2 For the gift tag, stick crosswise one strip of sellotape over the upper part of the casting mould.
- 3 Glue some sellotape onto the blunt side of the wooden skewer. Pierce the stretched sellotape in its middle with the wooden skewer and insert the glued blunt side of the skewer through.
- 4 Mix the berry-coloured pigment with the Raysin casting powder in a small vessel. Blend it evenly. According to the desired colour intensity, you have to put more or less pigment.
- 5 Mix the blended casting powder with water.
- 6 Then pour the colorfully stirred Raysin quickly into the mould.
- 7 After about 30 minutes, demould the gift tag. The wooden-skewer can be removed.
- 8 Remove afterwards the label with for e.g. the tip of the wooden skewer or a head pin.
- 9 Before attaching the gift tag to the gift with the string, allow it to dry out completely for several days.

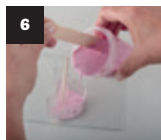

Rayher.

WWW.RAYHER.COM

You will find material specifications and instructions on our homepage.

