



CRAFTING IDEA

GB

ARTfully.
Artworks with dried flowers.

WWW.RAYHER.COM



Used items:

64 627 000	Canvas frame, 25 × 25 × 1.6 cm	1 piece
35 077 506	Allround Paint, acrylic, sandalwood	1/20 bottle
38 933 000	Structure paste, fine sand	¼ jar
62 400 000	Wooden chip box, round	1 piece
38 934 000	Structure paste, coarse sand	1/6 jar
42 000 504	Jute cord on wood card, ø 1.5 mm, sand	65 cm

Additionally you need:

38 032 00 Metallic spatula with flexible blade tip
27 000 505 Flower press
 Paintbrush, masking tape, hot-melt glue, flowers and blossoms to press



Instructions:

1 Press the flowers and blossoms according to the instructions of the flower press.

2 Paint the side edges of the canvas frame with acrylic paint and let them dry well out.

3 Stick the masking tape along the entire length, about 3 cm from the edge, and apply the Fine Sand structure paste to the middle part using the metallic spatula.

4 Remove the masking tape. Lay the dried flowers on the still wet structure paste and push them slightly down, in order to secure them in place as the paste dries.

5 Wrap a cord around the lid of the wooden chip box and secure it firmly using hot-melt glue. Spread the Coarse Sand structure paste over the lid using the metallic spatula and press down a dried flower into the still wet structure paste.

TIP: If need be, secure the dried flowers and blossoms in place by means of the hot-melt glue.

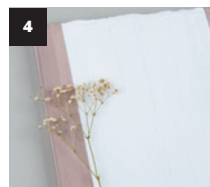
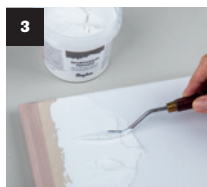
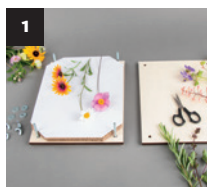

Rayher.

WWW.RAYHER.COM

More craft ideas and additional material information can be found on our website.

