



**HANDICRAFT TIP**

GB

Coiled & felted.  
Easter eggs and bunnies made  
out of styrofoam.



### Used items:

<b>30 162 000</b>	Styrofoam eggs full-form, ø 6 cm	5 pieces
<b>53 658 000</b>	Pure new wool, summer blend	1/20 bag
<b>42 000 104</b>	Jute cord on wooden card, ivory	approx. 8 m
<b>42 000 504</b>	Jute cord on wooden card, sand	approx. 5 m
<b>24 255 00</b>	Florist's wire, ø 0.5 mm	approx. 1.5 m
<b>46 738 505</b>	Wooden shapes Blossoms, natural	approx. 5 pieces
<b>85 108 02</b>	Decorative feather	approx. 5 pieces

### Additionally you need:

<b>53 278 000</b>	3-needle felting tool
<b>33 376 00</b>	Mini hot-melt glue gun, low temperature

Scissors, ruler

### Instructions:

**1** First cut off a piece of wool in the desired colour and wind it around the egg until about half the egg is covered. Start felting the wool by making small stitches with the felting tool. The more often and more densely you stitch, the more compactly the egg is felted. Ensure that the needle is inserted as vertically as possible.

**2** Cut 2.3 m of jute cord for each egg and affix it at the bottom of the egg with a tiny drop of hot-melt glue. From this starting point, wind the jute cord around the egg so that it lies side by side. Always use some hot-melt glue to affix it. The winding ends where the wool felt begins.

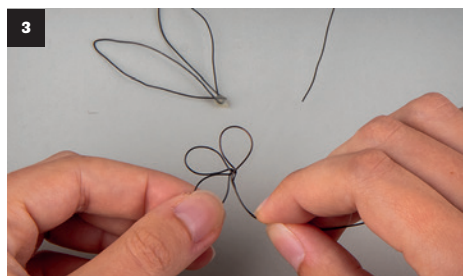

**3** Shape a piece of wire into a flower (of about 30 cm) or bunny ears (of about 20 cm) for each egg. Affix them with a bit of hot-melt glue and decorate them with the wooden flower-shaped pieces and decorative feathers to your liking.

**4** If you want to hang your egg, cut a piece of jute cord about 25 cm long, fold it in half and affix both ends to the felt wool by means of a tiny drop of glue.



## Used items:

<b>30 162 000</b>	Styrofoam eggs full-form, ø 6 cm	3 pieces
<b>53 658 000</b>	Pure new wool, summer blend	1/20 bag
<b>42 000 504</b>	Jute cord on wooden card, ø 1.5 mm, sand	3.3 m
<b>24 034 00</b>	Florist's wire, ø 0.65 mm	approx. 4 m
<b>55 951 685</b>	Baker's twine mix, pastel	0.2 m

## Additionally you need:

<b>53 278 000</b>	3-needle felting tool
<b>89 543 00</b>	Wire cutter
<b>89 541 00</b>	Flat round pliers

Scissors, ruler

## Instructions:

**1** For each bunny to be felted, cut off enough wool to cover the whole egg. Then stitch the wool using the felting tool. The more often and more densely you stitch, the more compactly your bunny is felted.

**2** To flatten the winding shafts with the florist's wire, stretch it with a round stick or pencil. Then prepare the pieces of wire to make the ears, eyes, mouth and whiskers, following submission. Bend the wire pieces as shown using the flat round pliers.

**3** You'll need 0.55 m of jute cord for each bunny ear. Affix the cord to the lower part of the ear by means of the hot-melt glue and wind it around the ear as shown to the right. The upper part of the ear is also affixed with a drop of hot-melt glue. Once both ears are wrapped in cord, insert the protruding pieces of wire into the styrofoam egg. A drop of glue is enough to hold them firmly in place.

**4** Then insert the eye-shaped and mouth-shaped wires in the felted egg. Use a small amount of felt wool for the nose and shape it into a ball. Fix the nose in the middle, below the eyes, with a few felting tool stitches. Insert 3 whiskers on both sides of the felted ball and affix the nose with a dot of hot-melt glue. In this way, the whiskers are also affixed.

**5** To complete the picture, create wire nests for the bunnies using various winding techniques. It would be much more original to twist the wire around you please. By winding the wire around your three fingers, you create an orderly nest, and by winding it around a wooden stick, you create a spiral whose ends can be joined together to form a nest.

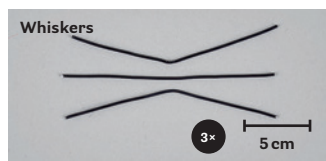
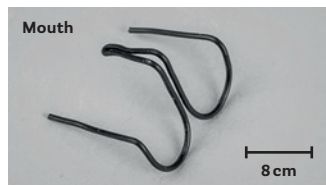
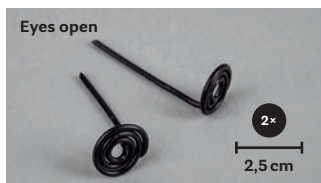
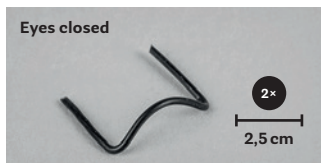
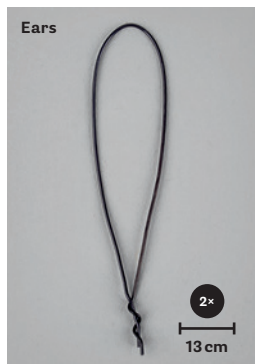



*Rayher.*

[WWW.RAYHER.COM](http://WWW.RAYHER.COM)

More craft ideas and additional material information can be found on our website.

© 2023, Rayher Hobby GmbH

